

DUPLEX UNIT INSTALLATION

ACCESSORY CHECK

Check the quantity and condition of the accessories in the box according to the following list:

- | | |
|---|-------|
| 1. Installation procedure
(115V: English only, 220V: five languages) | 1 |
| 2. New Equipment Condition Report | 1 |
| 3. Envelope - NECR (115V only) | 1 |
| 4. Duplex receiving tray | 1 |
| 5. Jogger unit cover | 1 |
| 6. Tray supporter | 1 |
| 7. Exit Roller Belt | 2 |
| 8. Cover Stopper | 1 |
| 9. Duplex Safety Switch Cover | 1 |
| 10. Pan head screw - M4 X 8 | 7 |
| 11. Truss screw - M4 X 8 | 4 |
| 12. Decal Misfeed D | 1 |
| 13. Multilingual decals (220/240V only) | 1 set |

INSTALLATION PROCEDURE

1. Remove the left (A) and rear (B) covers from the expansion unit (2 screws each).
2. Remove the front (C) and left (D) side expansion shipping brackets (4 screws each).
3. Remove the strips of shipping tape (E).

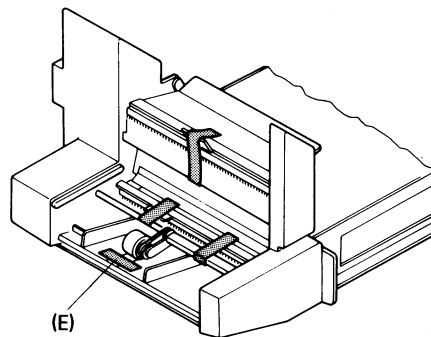
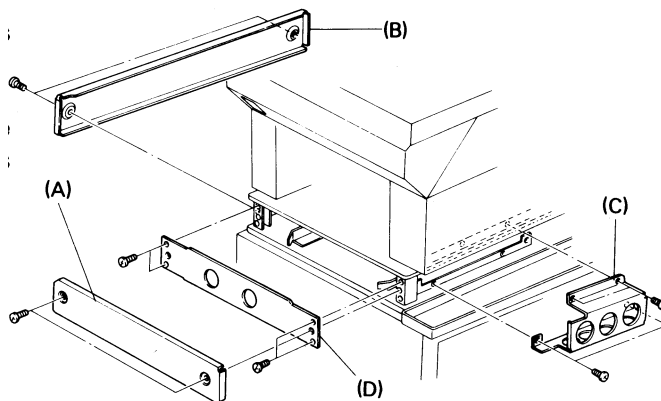

4. Remove the outer [A] and inner [B] front side duplex shipping brackets (outer - 2 screws, inner - 4 screws).
5. Remove the rear duplex shipping bracket [C] (1 screw).
6. Remove all three shipping stays [D] from the duplex unit (2 screws each).
7. If the mylar paper guide was previously installed, lower the guide plate lever of the expansion relay unit and remove the mylar paper guide.

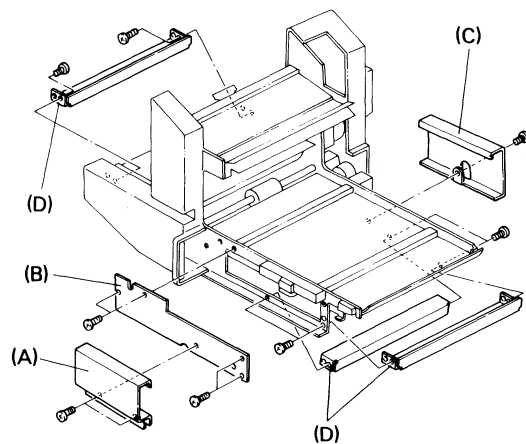

8. Remove the duplex harness hole cap [A] from the copier left cover.
9. Slide the duplex unit halfway into the expansion unit. Make sure that the duplex unit side plates [B] fit to the outside of the expansion unit rails [C].
 - ▶ When sliding the duplex unit into the expansion unit, lift the jogger unit by the sides to prevent the turn guide from being damaged.
10. Run the harness [D] into the copier through the duplex harness hole.
11. Slide the duplex unit all the way into the expansion unit.

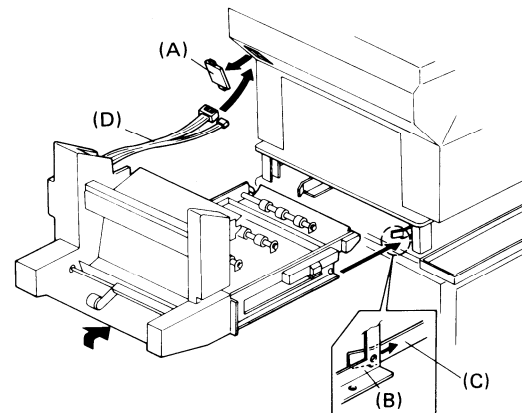

12. Secure the duplex unit [A] to the expansion unit [B] (4 screws).
13. Secure the cover stopper [C] to the duplex transport side plate (1 screw).
14. Install the duplex safety switch cover [D] (2 truss screws).
15. Stick "Misfeed Decal D" [E] in the position shown.

[Rear view]

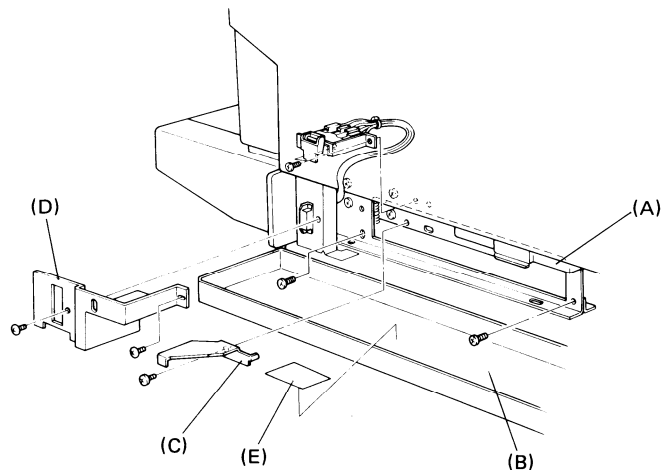
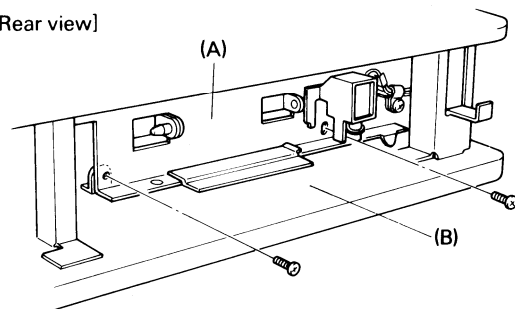

16. Install the duplex receiving tray [A] (2 truss screws and 2 long screws with washers) and the jogger unit cover [B].

- Remove the two long screws and the washers from the duplex unit and use them to install the duplex receiving tray.

17. Install the tray supporter [C] and copier receiving tray [D].

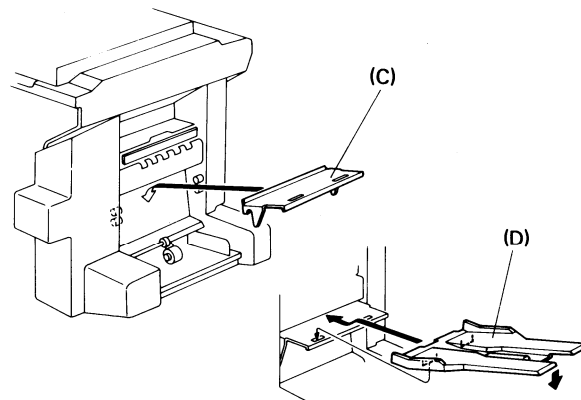
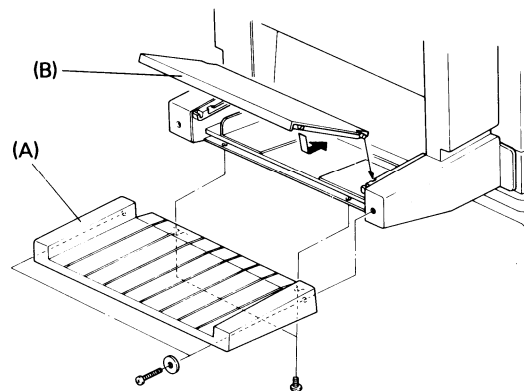

18. Remove the copier rear cover (3 screws) and install the interface board [A] on the PCB plate [B] (2 screws, 1 connector).

19. Connect the duplex harness to the copier as follows:

Black connector [C] to CN802 on the interface board

White connector [D] to white 2P connector on the ac harness

20. Turn on Dip switch 801-1 on the interface board [E].

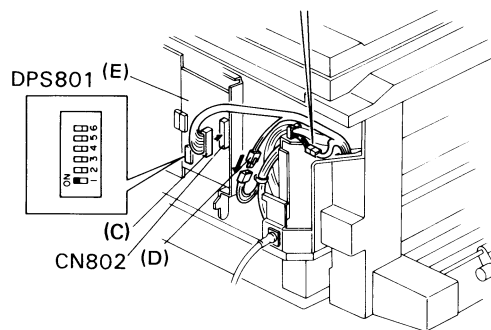
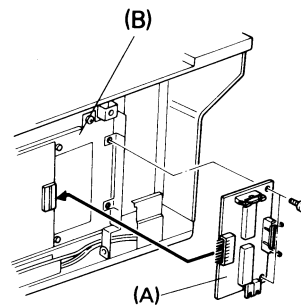

21. Pull out the fusing unit [A] and remove the 2 belts [B] off of the center exit roller.
22. Peel off the panel cover [C] on the left side of the operation panel.
23. Set the duplex key top (copier accessory [D]) and stick on the duplex key cover (copier accessory [E]) as shown.
24. Install all covers except the rear copier cover for sorter and DF installation.

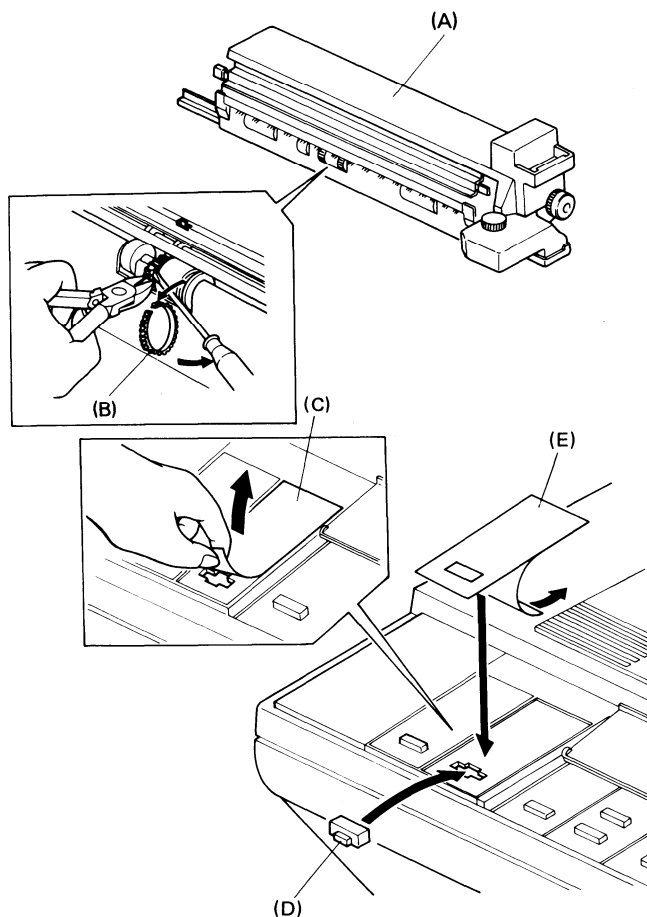

REPLACEMENT/ADJUSTMENT

1. POSITIONING ROLLER AND DRIVE BELT REPLACEMENT

NOTE: Remove the sorter if installed.

1. Remove the snap ring [A] and slide off the sponge positioning roller [B].
2. Remove the duplex front [C] and rear [D] covers (5 screws).
3. Remove the adjusting plate bracket [E] and the tray cover holder [F] (2 screws).
4. Remove the front E-ring and bushing from the positioning roller shaft.
5. Remove the positioning roller lift solenoid link [G] (1 E-ring). Be careful not to bend the lift shaft bracket [H].
6. Unhook the chain tensioning spring [I].
7. Move the positioning roller shaft [J] to the rear.
8. Remove the positioning roller drive belt as shown.
9. Install the new positioning roller drive belt [K] and positioning roller and reassemble.

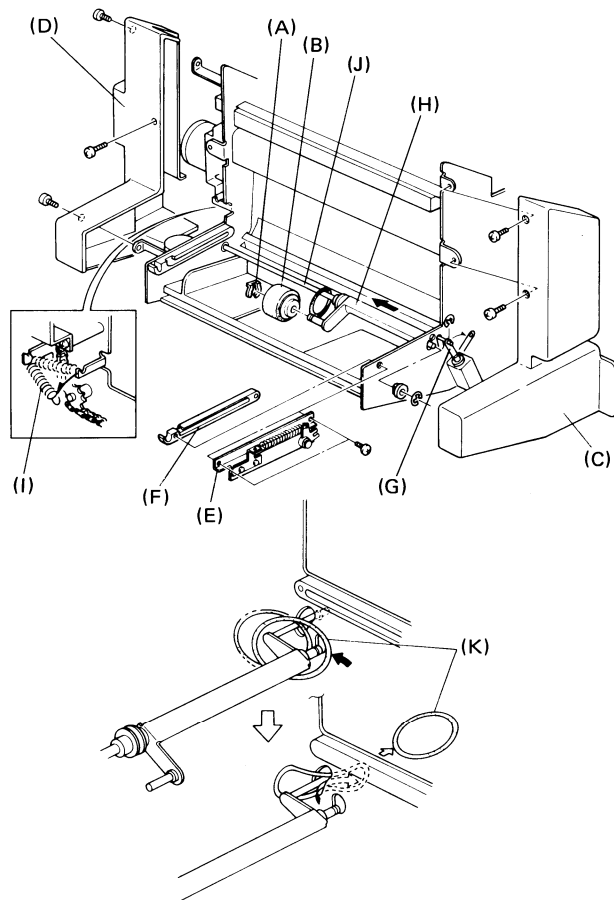

2. POSITIONING ROLLER PRESSURE ADJUSTMENT

NOTE: Positioning roller pressure adjustment may be required for paper that does not have standard thickness.

1. Remove the duplex front cover [A].
2. Adjust the positioning roller pressure by moving the adjusting plate [B].

For thin paper decrease the pressure.
For thick paper increase the pressure.

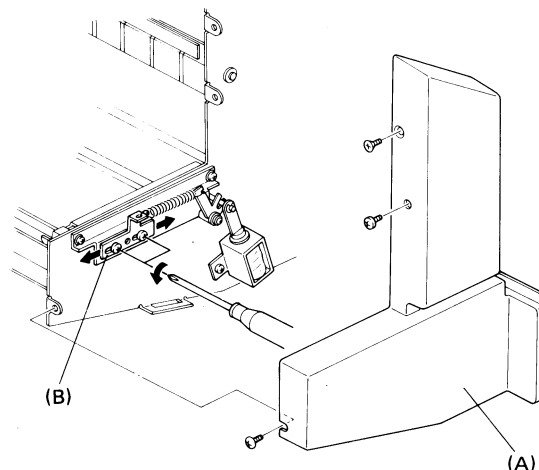

3. JOGGER HOME POSITION ADJUSTMENT

1. Turn off the main switch.
2. Connect the sensor checker (part number 52069600) to the jogger home position sensor [A]. Connect the red wire to the +5V test pin (TP105) and the black wire to the ground test pin (TP102) on the main board.
3. Move the rear jogger fence [B] 11.5 ± 0.5 mm from the jogger rear plate [C].
4. Turn on the main power switch.
5. Loosen the adjusting screw [D] and move the jogger home position sensor away from the actuator plate [E].
6. Move the sensor towards the actuator plate until the LED turns off.
7. Very carefully, move the sensor away from the actuator plate until the LED just lights. At this point tighten the adjusting screw and do not move the rear jogger fence.
8. Move the front jogger fence 321 ± 1 mm away from the rear jogger fence. Tighten the wire clamp screw [F].

